

IEL+x SOFT



Two-volume
revolving handles



ELESA Original design

SOFT

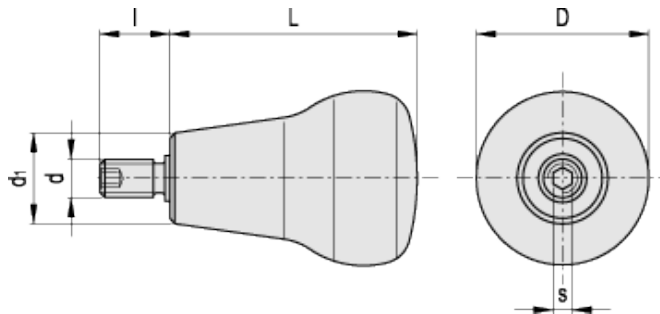

technical informations

Material

High-resilience polypropylene-based (PP) technopolymer coated with "soft-touch" thermoplastic elastomer (TPE) chemically bonded, hardness 70 Shore A.

The coating material is certified in compliance with FDA (U.S. Food and Drug Administration).

Resistant to solvents, oils, greases and other chemical agents.

Colour

Black, matte finish.

Standard executions

Zinc-plated steel shank, hexagon socket at threaded end.

- IEL+x: without ring.

- IEL+x-A: with matte anodised aluminium ring (ELESA original design).

Special executions on request

IEL+x-H: with magnifying lens for labels with marks and symbols.

Features and applications

Handles coated with "soft-touch" elastomer: it improves the grip even in the presence of oils, greases and sweat from the hand. Particularly suitable for applications on fitness machines, tools and machines for gardening and goods transport, high-precision instruments and disability aids.

Standard Elements		Main dimensions			Threaded shank			Weight
Code	Description	L	D	d ₁	d _{6g}	l	s	g
26651	IEL.47+x-M10 SOFT	47	45	28	M10	17	5	80
26681	IEL.65+x-M10 SOFT	65	45	23	M10	17	5	99
26691	IEL.65+x-M10-A SOFT	65	45	23	M10	17	5	99



ELESA and GANTER models all rights reserved in accordance with the law. Always mention the source when reproducing our drawings.

STANDARD MACHINE ELEMENTS WORLDWIDE